

# **NetworX Family Introduction**

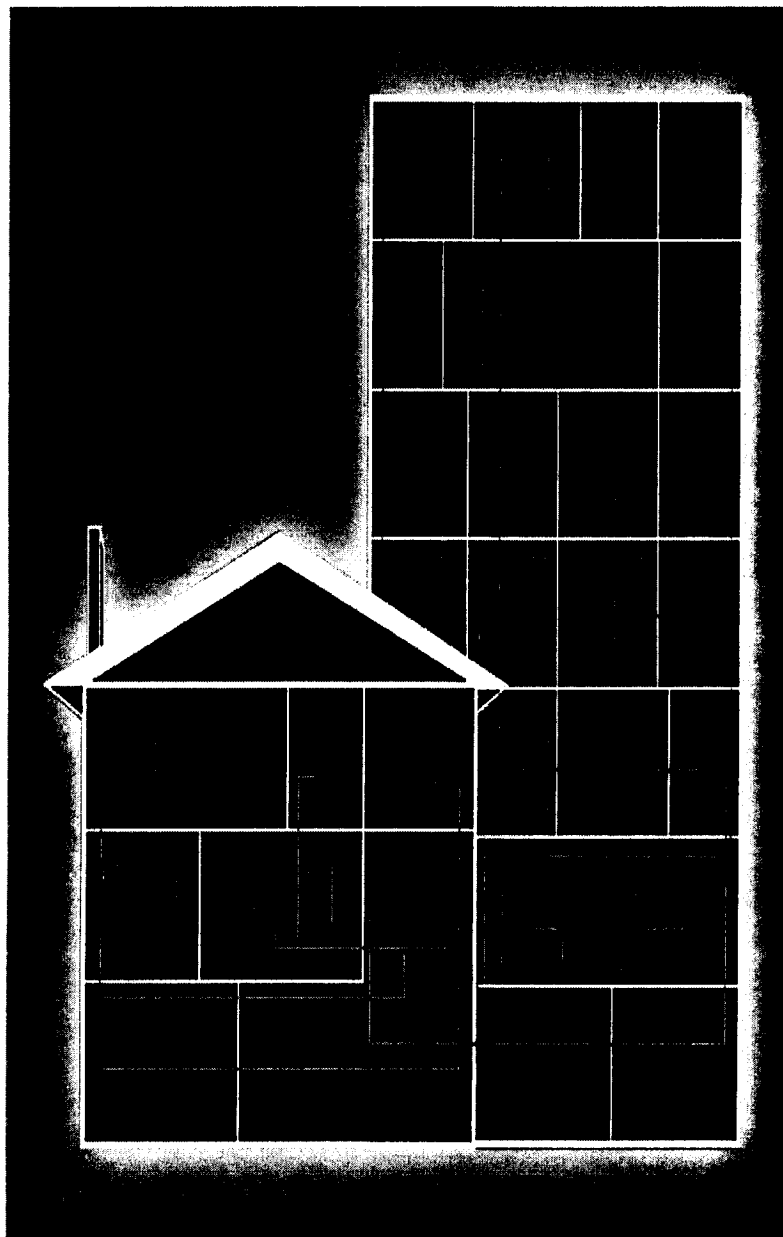

**Sentrol University  
Module 1**

## **Standardization Allows For:**

- **Lower overhead costs for the installation company**
- **Alarm companies can be trained on one control with:**
  - Consistent programming
  - Consistent wiring
  - Consistent downloading techniques
  - Consistent end user interface



**SENTROL**

## **CADDX NX Series Products**

- **Standardize with:**
  - Inventory
  - Scalable features
  - Programming map
  - Operation
  - Down-loader



**SENTROL**

## NX Series Controls

- **All zones programmable as fire or burglary**
- **20 customizable pre-configured zone types on NX-4, NX-6, and NX-8, 30 on NX-8E**
- **Up/downloadable with competitor lockout**
- **Fuseless design**
- **(4) on-board outputs on NX-8E, NX-8, and NX-6, (2) on NX-4**
  - (50 events programmable by partition)



SENTROL

## NX Series Controls

- **2-wire or 4-wire smoke detectors on NX-8E, NX-8, and NX-6, 4-wire only on NX-4**
- **Force arming by zone type**
- **Automatic arming with auto retry**
  - (In the exit mode ONLY)



SENTROL

## **NX Series Controls**

- **Built-in siren driver/voltage out**
- **Voltage and current telephone line monitor on the NX-8E, NX-8, and NX-6**
- **Dynamic battery test**
- **Box tamper input**



**SENTROL**

## **System Specifications NX-8E**

- **8 zones, 8 partitions, 240 users**
- **Zone expansion to 192 hardwire or wireless zones**
- **Maximum of 8 keypads per partition**
- **Maximum of 24 keypads per system**
- **Maximum of 32 devices per system**
  - Includes keypads and expansion modules



**SENTROL**

## **System Specifications NX-8E**

- **512 event history log**
  - Date
  - Time
  - Event
  - Partition number
  - User number



**SENTROL**

## **System Specifications NX-8**

- **8 zones, 8 partitions, (99) 4-digit users or (66) 6-digit users**
- **Zone expansion to 48 hardwire or wireless zones**
- **Maximum of 8 keypads per partition**
- **Maximum of 24 keypads per system**
- **Maximum of 32 devices per system**
  - Includes keypads and expansion modules



**SENTROL**

## **System Specifications NX-8**

- **185 event history log**
  - Date
  - Time
  - Event
  - Partition number
  - User number



**SENTROL**

## **System Specifications NX-6**

- **6 or 7 zones (7 when using 2-wire smoke detectors), 2 partitions, 40 users**
- **Zone expansion available to 16 zones**
  - Hardwire using zone doubling (12 zones maximum)
  - Wireless using wireless receiver (16 zones maximum)
- **Maximum of 8 keypads per partition**
- **Maximum of 3 modules per system**

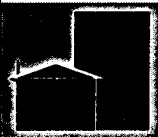

**SENTROL**

## **System Specifications NX-6**

- **185 event history log**
  - Date
  - Time
  - Event
  - Partition number
  - User number



**SENTROL**

## **System Specifications NX-4**

- **4 zones, 1 partition, 8 users**
- **Zone expansion available to 8 zones**
- **Hardwire using zone doubling**
  - *Zone doubling only when using more than one keypad or an additional module*
- **Wireless via RF receiver**
  - *No key-switch arming capability*
  - *No telephone line monitor*



**SENTROL**

## **System Specifications NX-4**

- **Maximum of 8 keypads**
- **Maximum of 1 module per system**
- **185 event history log**
  - Date
  - Time
  - Event
  - Partition number
  - User number



**SENTROL**

## **NetworX Keypads**

- **Keypad Options:**
  - NX-108, 116, or 124 LED keypads
  - NX-1308, 1316 or 1324 LED keypads with door
  - NX-148 - Alphanumeric LCD keypad with door
- **Maximum keypad or module distance is 2,500 feet from the panel**
- **Backlit keys with audible feedback**
- **Armed, Ready, Power, and Service LED's**



**SENTROL**



## NetworX Keypads

- **Independently adjustable keypad tones**
  - Independently silence keypad tones
- **Full keypad supervision**
- **Alarm memory feature**
- **Set system date and time**
- **Down-load call back initiation**



**SENTROL**

## Additional Modules

- **NX-216 16 zone hardwire expander (NX-8 and NX-8E only)**
- **NX-408, 416, 448 Wireless receivers**
- **NX-507 7 relay, 1 O/C and 8 output X-10 module**
- **NX-508 8 output X-10, O/C and parallel printer module**
- **NX-320 Smart power supply and bus extender**



**SENTROL**

## **Additional Modules**

- **NX-534 Listen-in and 2 way voice module**
- **NX-540 "Operator II" telephone interface module**
- **NX-580 Uplink interface**
- **NX-582 AES Intellinet interface**
- **NX-584 Home automation interface**
- **NX-870 Fire module**



**SENTROL**

## **SIA False Alarm Prevention Features**

- **Audible/visual exit delay countdown warning**
- **Exit error reporting**
- **Recent closing reports**
- **Programmable abort delay**
- **Cross zoning**
- **Swinger shutdown by zone type**
- **Fire alarm verification**



**SENTROL**

## **Audible / Visual Exit Delay Countdown Warning**

- **Keypad beeps slowly until the last 10 seconds of the exit delay**
- **During the last 10 seconds the keypad beeps quickly, and the exit light flashes**



SENTROL

## **Exit Error Reporting**

- **A special report to the central station that indicates the exit door had not closed at the time the exit delay expired**
- **Indicates to the central station that the alarm was caused by user error**

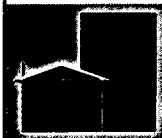

SENTROL

## Recent Closing Reports

- **Advises the central station that a zone alarm occurred within 5 minutes of a closing**
- **This will let the central station know that there is the possibility of an improper arming or exit**



**SENTROL**

## Programmable Abort Delay

- **Alarm can be programmed to delay reporting to central station**
- **Siren or bell will sound**
- **User can enter code and "Cancel" button to prevent signal being sent to central station**
- **Visible confirmation of cancellation**
- **Prevents user caused alarms**
- **Can be programmed to abort with only the user code**

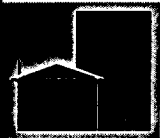

**SENTROL**

## Cross Zoning

- **Requires 2 trips from separate zones to cause alarm**
- **Useful for eliminating pet problems**
- **Useful for eliminating false alarms**
- **Set two or more zones as cross zones, then set cross zone time**
- **Setting a single zone as a cross zone will cause a double trip zone, "double knock"**



SENTROL

## Swinger Shutdown By Zone

- **Control panel will only report a fault on the zone a programmable number of times before bypassing that zone**
- **Used to limit problems caused by a single detector**
- **Programmable by zone**
- **Only affects a single arming cycle**



SENTROL

## **Fire Alarm Verification**

- **Requires 2 trips of a smoke detector**
- **First trip causes panel to reset smoke power**
- **Second trip within a programmable period of time causes alarm**
- **Reduces system caused false alarms**

